

Name: <u>Jarkko Hyvärinen</u>		Date: <u>30/4/2012</u>	Event: <u>WJ Helsinki 2012</u>
City: <u>helsinki</u>		State: _____	
Track: <u>Model Expo 2012</u>			

Track Conditions	<input checked="" type="checkbox"/> Indoor	<input checked="" type="checkbox"/> Tight	<input type="checkbox"/> Smooth	<input type="checkbox"/> Hard Packed	<input type="checkbox"/> Blue Groove	<input type="checkbox"/> Wet	<input type="checkbox"/> Grass	<input type="checkbox"/> Low Bite	<input type="checkbox"/> High Bite
	<input type="checkbox"/> Outdoor	<input type="checkbox"/> Open	<input type="checkbox"/> Rough	<input type="checkbox"/> Loose/Loamy	<input type="checkbox"/> Dry	<input type="checkbox"/> Dusty	<input type="checkbox"/> Astro Turf	<input checked="" type="checkbox"/> Med Bite	<input checked="" type="checkbox"/> Other <u>Painted Concrete / Carpet</u>

Front Suspension

Toe: 0°

Ride Height: 21mm

Camber: 2°

Caster: ☐ 0° ☐ 3° ☐ 5° ☒ 10°

Kick Angle: ☒ 20° ☐ 25° ☐ 30°

Sway Bar: None

Oil: Core 300

Piston: TLR 55 4 hole

Spring: Red

Spindle Type: ☒ Inline ☐ Trailing

Shock Limiters: 2mm

Shock Location: 2 - Middle

Bump Steer: 1mm

Camber Link: 1

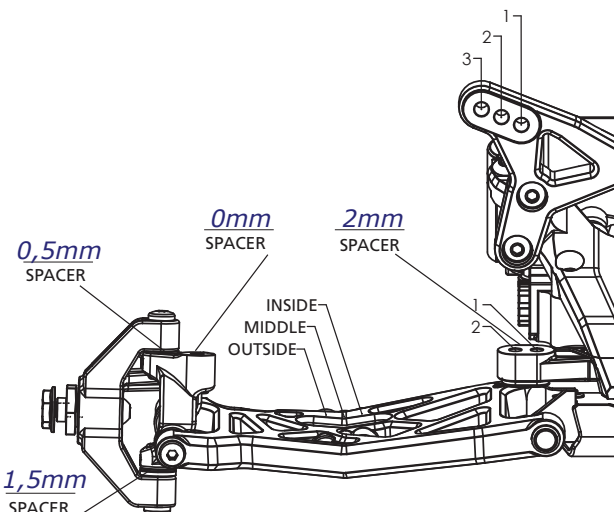

Notes: _____

Spindle position: back - short wheelbase

Rear Suspension

Chassis Configuration: ☒ Rear Motor ☐ Mid Motor

Toe: 4°

Anti-Squat: 1mm

Roll Center: ☒ Low Roll Center (LRC) ☐ High Roll Center (HRC)

Ride Height: 21mm

Camber: 1°

Rear Hub Spacing: Hub front - short wheelbase

Hex Width: Std

Sway Bar: None

Oil: Core 300

Piston: TLR 55 4 hole

Spring: Yellow

Shock Limiters: 0 - 2 turns out

Camber Link: 1 - B

Shock Locations: 2 - Inside

Wing/Wickerbill: Jc High clearance 165mm /

Battery Position: Mid

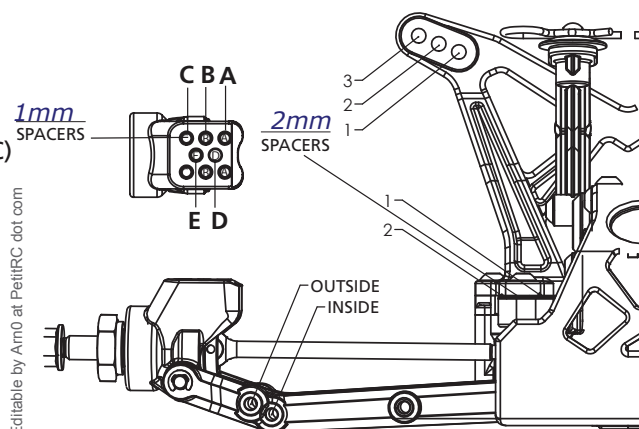

Electronics

Radio: <u>KO</u>	Timing Advance: <u>-10</u>
Servo: <u>KO One10</u>	Throttle/Brake Expo: <u>0</u>
ESC: <u>Nosram v2 firm v3.0</u>	Servo Expo: <u>0</u>
Initial Brake: <u>0</u>	Throttle/Brake EPA: <u>100/75</u>
Drag Brake: <u>0</u>	Motor: <u>Nosram 8.5</u>
Throttle Profile: <u>1/4/1/0</u>	Pinion: <u>22</u> Spur: <u>76</u>
	Battery: <u>Xcelorin Shorty</u>

Weight Placement
(Mark with "X")

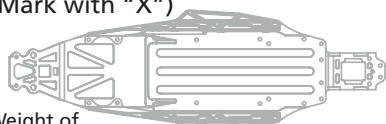

Weight of
each piece _____ oz./g

Tires	Compound	Insert	Additive
Front: <u>Mini pin 4wd</u>		<u>Sch med</u>	
Rear: <u>Mini pin</u>		<u>Sch med</u>	

Notes: RTR22 gear diff UR5000 cst, AE vented slipper, TLR Alu camber blocks, Jc Finisher, weight 1570g. Tires: Front (Slightly worn), rear (Worn)