

Reset



Name Tuomas Lindgren  
 Date 2016  
 Track Lavanko  
 Temperature \_\_\_\_\_  
 Weather \_\_\_\_\_

Tight ☒ Low Grip  
 Medium ☒ Medium Grip  
 Open ☒ High Grip  
 Smooth ☒ Dusty  
 Rough ☒ BlueGroove



## FRONT

## Ackermann

☐ FRONT  
☒ MIDDLE  
☐ REAR

## Caster

☐ 14°  
☒ 16°

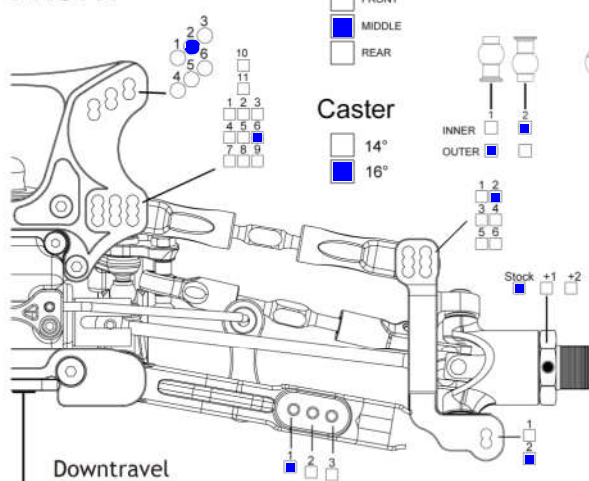

## Kick-up

F-F

1  
 .5  
 0  
 .5  
 1

F-R

1  
 .5  
 0  
 .5  
 1

## Antisquat

R-F

1  
 .5  
 0  
 .5  
 1

## Toe-in

R-R

Right

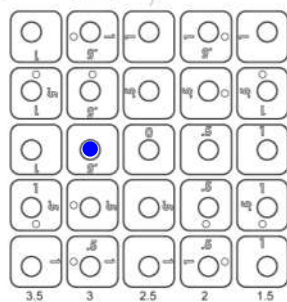

## REAR

## Rear Hub Position

☐ FRONT  
☒ MIDDLE  
☐ REAR

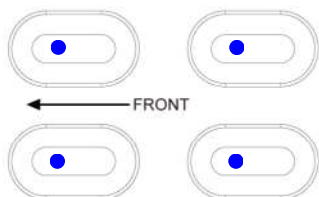
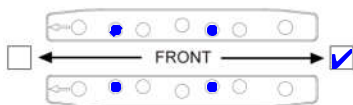
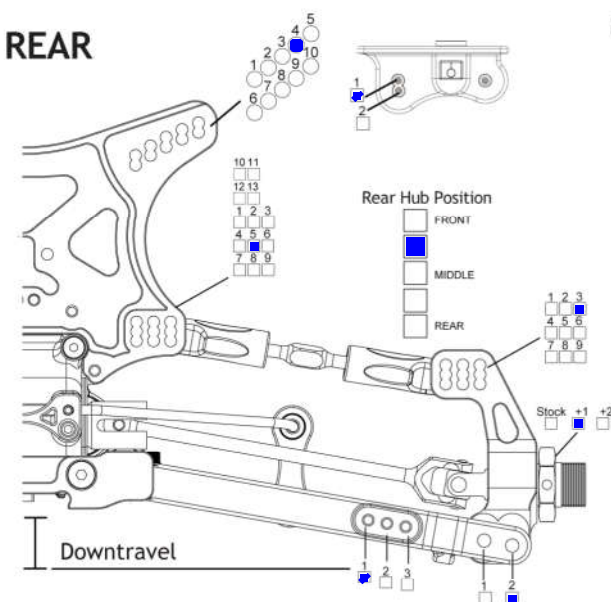

Car Weight

g

Engine

Plug

Fuel

Pipe

Clutch

Clutch Spring

Best Laptime

Runtime

Best result

Qualifying

Final

## NOTES

	FRONT	REAR
* Ride Height		
Downtravel		
Swaybar	Vakio	Vakio
Brake Balance	60 %	40 %
Camber	Length: mm Degree: 1.5	Length: mm Degree: 3.5
Steering Link / Front Toe	Length: mm Degree: 2	

## SHOCKS

Oil wt / Brand	500	400
Piston	7x1,2	7x1,3
Spring	Gray	Gray
Length	Preload: mm Total: mm	Preload: mm Total: mm
Rebound	0	0

## TYRES

Tread / Brand		
Compound		
Insert		
Wheel		
Tyre Set Weight		g

## DIFFS

	FRONT	CENTER	REAR
Oil wt / Brand	10000	12500	3000
Gear ratio (main/pinion)	45/14	46/13	45/14