

Name: <u>Henry Salmén</u>		Date: <u>14.6.2014</u>	Event: <u>Maastosarja 1</u>
City: <u>Vaasa, Finland</u>		Track: <u>Vaasa outdoor</u>	
Track Conditions	<input type="checkbox"/> Indoor <input checked="" type="checkbox"/> Outdoor	<input type="checkbox"/> Tight <input checked="" type="checkbox"/> Open	<input checked="" type="checkbox"/> Smooth <input type="checkbox"/> Rough
	<input checked="" type="checkbox"/> Hard Packed <input type="checkbox"/> Loose/Loamy	<input checked="" type="checkbox"/> Blue Groove <input checked="" type="checkbox"/> Dry	<input type="checkbox"/> Wet <input type="checkbox"/> Dusty
	<input type="checkbox"/> Grass <input type="checkbox"/> Astro Turf	<input type="checkbox"/> Low Bite <input checked="" type="checkbox"/> Med Bite	<input type="checkbox"/> High Bite <input type="checkbox"/> Other _____

Front Suspension

Toe: -1°
 Ride Height: 24mm
 Camber: -1°
 Caster: ☒ 0° ☐ 5° Trail: ☐ 2mm ☒ 4mm
 Kick Angle: ☐ 20° ☒ 25° ☐ 30°
 Sway Bar: -
 Oil: TLR 32,5W
 Piston: 2x1.6
 Spring: ☐ Standard ☒ Low Freq. Color: Orange
 Front Pivot: ☒ Aluminum ☐ Plastic ☐ HRC
 Kick Shim: ☐ Brass ☒ Plastic
 Shock Limiters: 2mm
 Shock Location: 2 - outside
 Bump Steer Ball Stud: ☒ Standard ☐ Low Mount
 Bumper Steer Spacers: 1mm
 Ackermann Ball Stud: ☒ Standard ☐ Low Mount
 Ackermann Spacers: 0mm
 Camber Link: Outside - 2

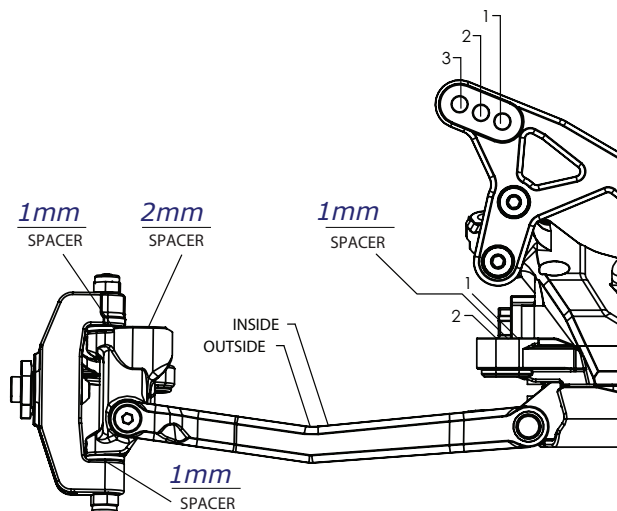

Notes: TLR Cab forward bodyshell, stock slider steering

Rear Suspension

Chassis Configuration: ☐ Rear Motor ☒ Mid Motor
 Toe: 3,5°
 Anti-Squat: 2°
 Roll Center: ☒ Low Roll Center (LRC) ☐ High Roll Center (HRC)
 Ride Height: 24mm
 Camber: -1
 Rear Hub Spacing: 2mm front, 2mm back
 Hex Width: standard
 Sway Bar: -
 Oil: TLR 27,5W
 Piston: 2x1,7
 Spring: ☐ Standard ☒ Low Freq. Color: White
 Shock Limiters: -
 Camber Link: D - 1
 Shock Locations: 1 - middle
 Wing/Wickerbill: TLR 7" wicker cut to 0
 Battery Position: Saddle pack in standard location

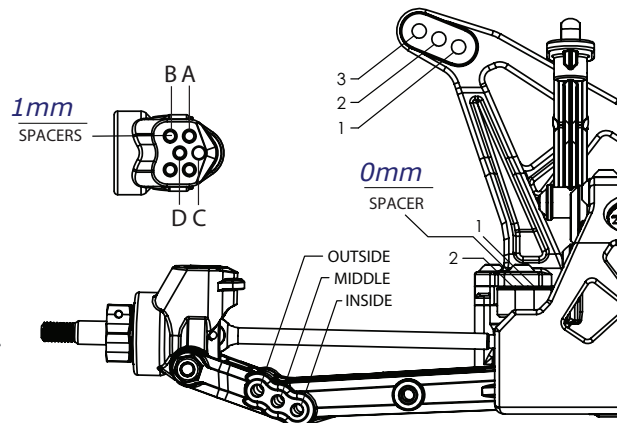

Electronics

Radio: Spektrum DX4R Pro
 Servo: Spektrum S6070
 ESC: Hobbywing V3.1
 Initial Brake: _____
 Drag Brake: 6%
 Throttle Profile: 10
 Timing Advance: 20
 Throttle/Brake Expo: - / -
 Servo Expo: -
 Throttle/Brake EPA: 100/75
 Motor: Dynamite 8.5t
 Pinion: 22 Spur: 78
 Battery: TP 5000mah saddle pack

Weight Placement
(Mark with "X")

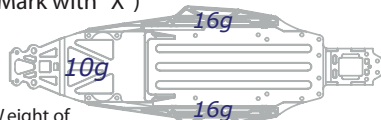

Weight of each piece _____ oz./g

Tires

Front: Proline Scrubs

Rear: Proline Holeshoot 2.0 M4

Notes: Super easy to drive and fast.

Compound

M3

M4

Insert

Stock foam

Stock foam

Additive

-

-