

Name: _____	Date: _____	Event: _____
City: _____	State: _____	Track: _____



Track Conditions	<input type="checkbox"/> Indoor	<input type="checkbox"/> Tight	<input type="checkbox"/> Smooth	<input type="checkbox"/> Hard Packed	<input type="checkbox"/> Blue Groove	<input type="checkbox"/> Wet	<input type="checkbox"/> Grass	<input type="checkbox"/> Low Bite	<input type="checkbox"/> High Bite
	<input type="checkbox"/> Outdoor	<input type="checkbox"/> Open	<input type="checkbox"/> Rough	<input type="checkbox"/> Loose/Loamy	<input type="checkbox"/> Dry	<input type="checkbox"/> Dusty	<input type="checkbox"/> Astro Turf	<input type="checkbox"/> Med Bite	<input type="checkbox"/> Other _____

Front Suspension

Toe: _____
 Ride Height: _____ Camber: _____
 Caster: ☐0° ☐5°
 Kick Angle: ☐20° ☐25° ☐30°
 VLA Setting: ☐Short Arm ☐Long Arm
 Front Pivot: ☐Alum ☐Plastic ☐HRC ☐Alum HRC
 Kick Shim: ☐Brass ☐Plastic
 Oil: _____
 Piston: _____
 Spring: ☐Standard ☐Low Freq. Color: _____
 Sway Bar: ☐0.8mm ☐1.0mm ☐1.2mm ☐_____
 Shock Limiters: _____ Stroke: _____
 Shock Locations: _____
 Spindle Ball Stud: ☐Standard ☐Low Mount
 Bump Steer Spacers: _____
 Ackerman Ball Stud: ☐Standard ☐Low Mount
 Ackerman Spacers: _____
 Ackerman Arm: ☐#1 ☐#2 ☐#3 ☐_____
 Axle Spacing: ☐0 ☐+0.5mm ☐+1mm
 Trail: ☐2mm ☐3mm ☐4mm
 Camber Link: _____

Stiffezel Parts:

- ☐Front Arm ☐Rear Arm
☐Chassis Brace
☐Front Camber Block
☐_____

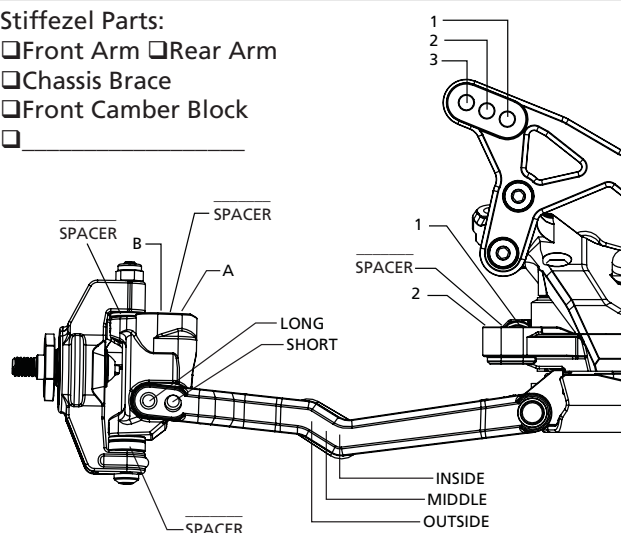

Notes: _____

Rear Suspension

Configuration: ☐Laydown ☐Standup
 LD Diff. Height: ☐Standard ☐+3.5mm
 Transmission Type: ☐3-Gear ☐4-Gear
 Toe Inserts: ☐0.5 ☐1 ☐1.5 ☐2 ☐2.5 ☐3 ☐3.5 ☐4
 Anti-Squat Inserts: ☐0 ☐0.5 ☐1 ☐1.5 ☐2 ☐2.5 ☐3
 Inner Roll Center: ☐LRC ☐HRC
 Ride Height: _____ Camber: _____
 Rear Hub Spacing: _____
 Rear Axle Height: ☐Standard ☐+3mm
 Hex Width: _____
 Sway Bar: ☐1.0mm ☐1.2mm ☐1.4mm ☐_____
 Oil: _____
 Piston: _____
 Spring: ☐Standard ☐Low Freq. Color: _____
 Shock Limiters: _____ Stroke: _____
 Shock Locations: _____
 Shock Mounting: ☐Front ☐Rear
 Inner Link Spacer: ☐-1mm ☐0mm ☐+1mm
 Camber Link: _____
 Wing/Wickerbill: _____
 Wing Angle: ☐0° ☐2° ☐4°
 Battery Position: _____
 Diff Type: ☐Ball ☐Gear Setting: _____
 Driveshaft Length: ☐CVA ☐Universal Length: _____

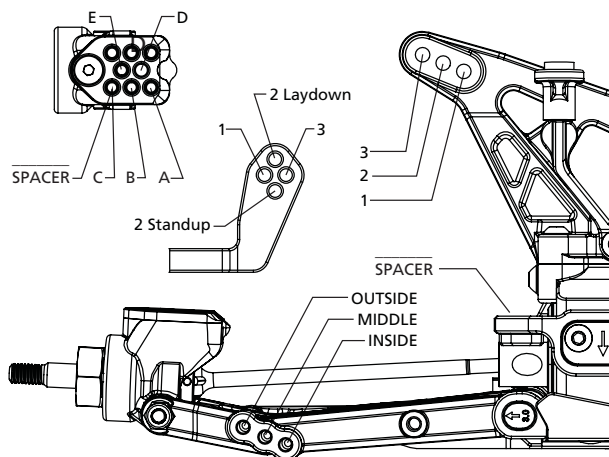

Electronics

Radio: _____	Timing Advance: _____
Servo: _____	Throttle/Brake Expo: _____
ESC: _____	Servo Expo: _____
Initial Brake: _____	Throttle/Brake EPA: _____
Drag Brake: _____	Motor: _____
Throttle Profile: _____	Pinion: _____ Spur: _____
	Battery: _____

Chassis

Servo Plate ☐Brass, 14g ☐_____
 Electronics Plate ☐Brass, 25g ☐_____
 ☐Brass, 50g ☐_____
 Battery Plate ☐_____
 Anti-Squat Block ☐Brass, 27g ☐Aluminum
 Front Pivot ☐Brass Pivot, 50g ☐Brass Kick Shim, 7g
 Rear Ballasts ☐Brass, 25g ☐Brass, 50g

Tires

	Front	Rear
Tire: _____		
Compound: _____		
Insert: _____		
Additive: _____		
Notes: _____		

