

Name: Henry Salmén

Date: 15.6.2014

Event: Maastosarja 1

City: Vaasa, Finland

State: _____

Track: Vaasa outdoor

Track Conditions: ☐ Indoor ☐ Tight ☒ Smooth ☒ Hard Packed ☒ Blue Groove ☐ Wet ☐ Grass ☐ Low Bite ☐ High Bite
☒ Outdoor ☒ Open ☐ Rough ☐ Loose/Loamy ☒ Dry ☐ Dusty ☐ Astro Turf ☒ Med Bite ☐ Other _____

Front Suspension

Toe: -2

Ride Height: 21mm

Camber: -1

Caster: ☒ 10° ☐ 15° ☐ 20°

Sway Bar: -

Oil: TLR 35W

Piston: #55 drilled from blank machined piston

Spring: ☒ Standard ☐ Low Freq. Color: Green

Shock Limiters: 2mm

Shock Location: 2 - inside

Bump Steer Ball Stud: ☒ Standard ☐ Low Mount

Bumper Steer Spacers: 4mm

Camber Link: 2

Ackermann: B

Notes: Shocks might be better with 2x1.6 piston in front, 2x1.7 piston in rear

Clicker oneway with silver spring.

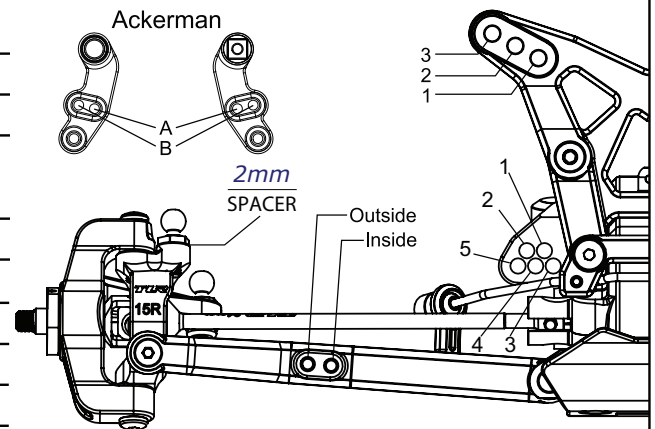

- ☒ TLR331012 Aluminum Servo Mount
- ☐ TLR334007 Aluminum Front Spindle
- ☐ TLR334009 Aluminum Steering Bellcrank

Rear Suspension

Toe: 3

Anti-Squat: 3

Roll Center: ☐ Low Roll Center (LRC) ☒ High Roll Center (HRC)

Ride Height: 23mm

Camber: -1

Rear Hub Spacing: 2mm front, 2mm back

Hex Width: std

Sway Bar: Pink

Oil: TLR 30W

Piston: #54 drilled from blank machined piston

Spring: ☒ Standard ☐ Low Freq. Color: Yellow

Shock Limiters: 0mm

Camber Link: 2 - B

Shock Locations: 3 - inside

Wing/Wickerbill: TLR 7", wicker cut to 0mm

Battery Position: Left pack forward

Notes: _____

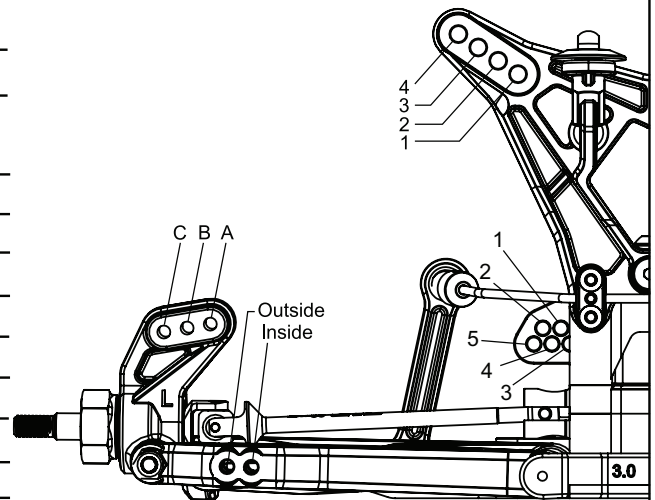

- ☐ TLR334008 Aluminum Rear Hub

Editable by Am0 at Petlirc.com

Electronics

Radio: Spektrum DX4R Pro

Servo: Spektrum S6040

ESC: Hobbywing V3.1

Initial Brake: _____

Drag Brake: _____

Throttle Profile: _____

Timing Advance: _____

Throttle/Brake Expo: _____

Servo Expo: _____

Throttle/Brake EPA: 100/80

Motor: Hobbywing V10 6.5t

Pinion: 18 Spur: 84

Battery: TP 5000mah

Tires

Front: JC DoubleDees

Rear: JC DoubleDees

Notes: _____

Compound

Insert

Additive

Green

And1

-

Green

PL ClosedCell

-